



RESIDENTIAL ESTATE AGENTS
PROPERTY LETTING & MANAGING AGENTS
VALUERS & PROPERTY CONSULTANTS
CHARTERED SURVEYORS

01722 336422
www.hwwhite.co.uk WEB



Denison Rise,

£850 PCM

15 Denison Rise, Salisbury, Wiltshire, SP1 3EW



Energy Efficiency Rating		
	Current	Potential
Very energy efficient - lower running costs		
(92 plus) A		
(81-91) B		
(69-80) C	73	77
(55-68) D		
(39-54) E		
(21-38) F		
(1-20) G		
Not energy efficient - higher running costs		
England & Wales		EU Directive 2002/91/EC

A well presented newly decorated one bedroom first floor flat with garden in Bishopdown, with excellent bus connections. Accommodation comprises fitted kitchen complete with integral NEFF appliances; including double oven complete with grill and microwave functions, fridge/freezer and gas hob. Sitting room, with leather corner sofa remaining in situ. Spacious hallway with storage cupboard, bathroom with shower (no bath), master bedroom with fitted furniture/wardrobes, gas central heating and double glazed windows. Off the communal landing is a secure cupboard housing washing machine facility. Outside there is a large garden, accessed via a communal path adjacent to shed. On street parking. UNFURNISHED.

First Floor

Approx. 41.5 sq. metres (447.1 sq. feet)

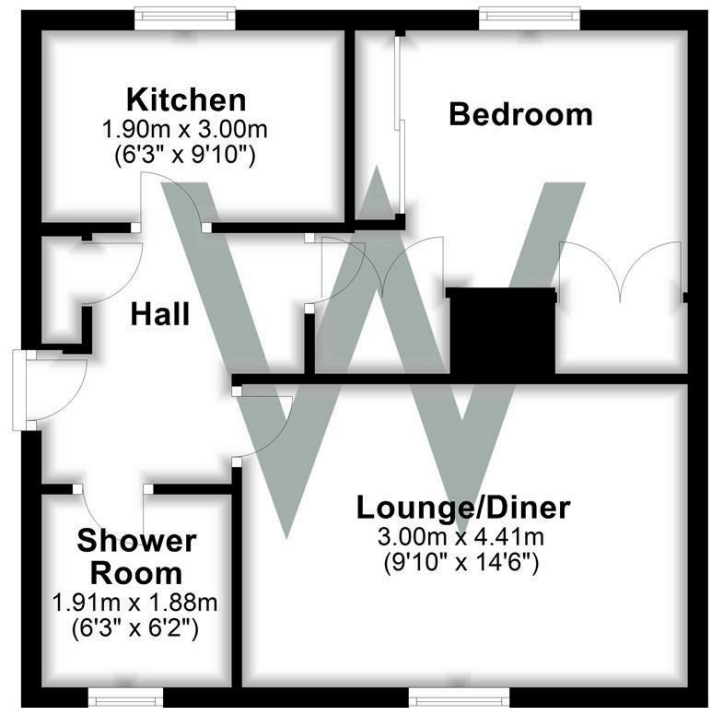

Total area: approx. 41.5 sq. metres (447.1 sq. feet)



01722 336422

47 Castle Street, Salisbury SP1 3SP 01722 320600 FAX
 residential-sales@hwwhite.co.uk E-MAIL www.hwwhite.co.uk WEB